

Assembly / Disassembly Directions for the Dramm #300 Brass Valve Repair Kit

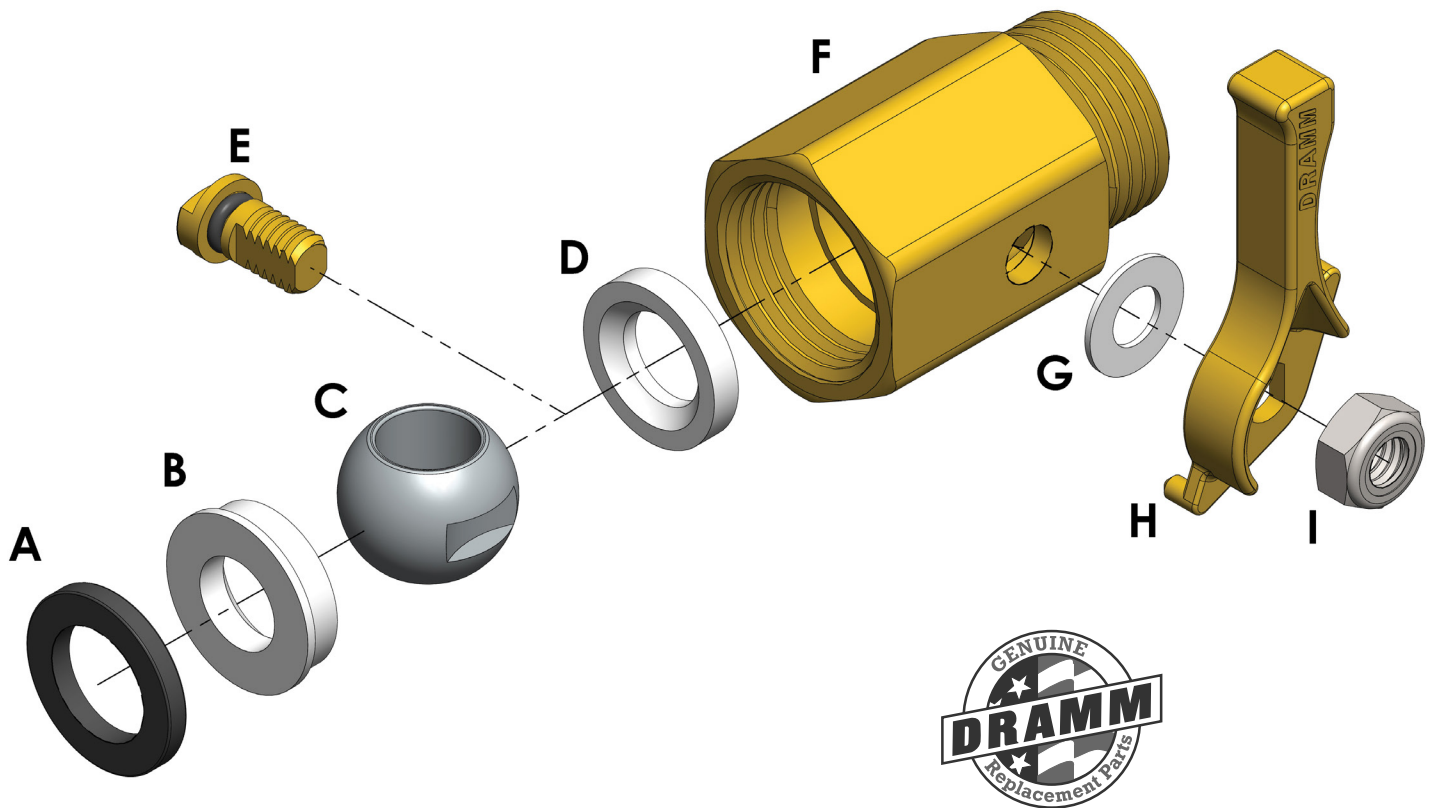

DISASSEMBLY

1. Remove the hose washer (A) from the female end of the valve.
2. Rotate the valve handle (H) until the valve is in the closed position.
3. Remove the nut (I) holding the handle (H) in place.
4. Insuring the valve stays in the off position remove the handle (H).
5. Push on the ball (C) from the male end, forcing the ball (C) and seal (B) assembly from the body (F).
6. Remove the stem (E) from the body (F) by pushing it inward.
7. Remove the front seal (D) from the valve body (F).



ASSEMBLY

1. Install new front seal (D).
2. Install stem (E) into body (F) and line up the end to accept the valve ball (C).
3. Install the ball (C) into the valve body (F).
4. Install the rear seal (B).
5. Install the hose washer (A).
6. Place the nylon washer (G) over the stem (E).
7. Install the handle (H) and lock nut (I).
8. The ease of handle movement is adjusted by tightening or loosening the lock nut (I).